

Datasheet
Rustic market hut "6m hut"
6.00m x 2.15m

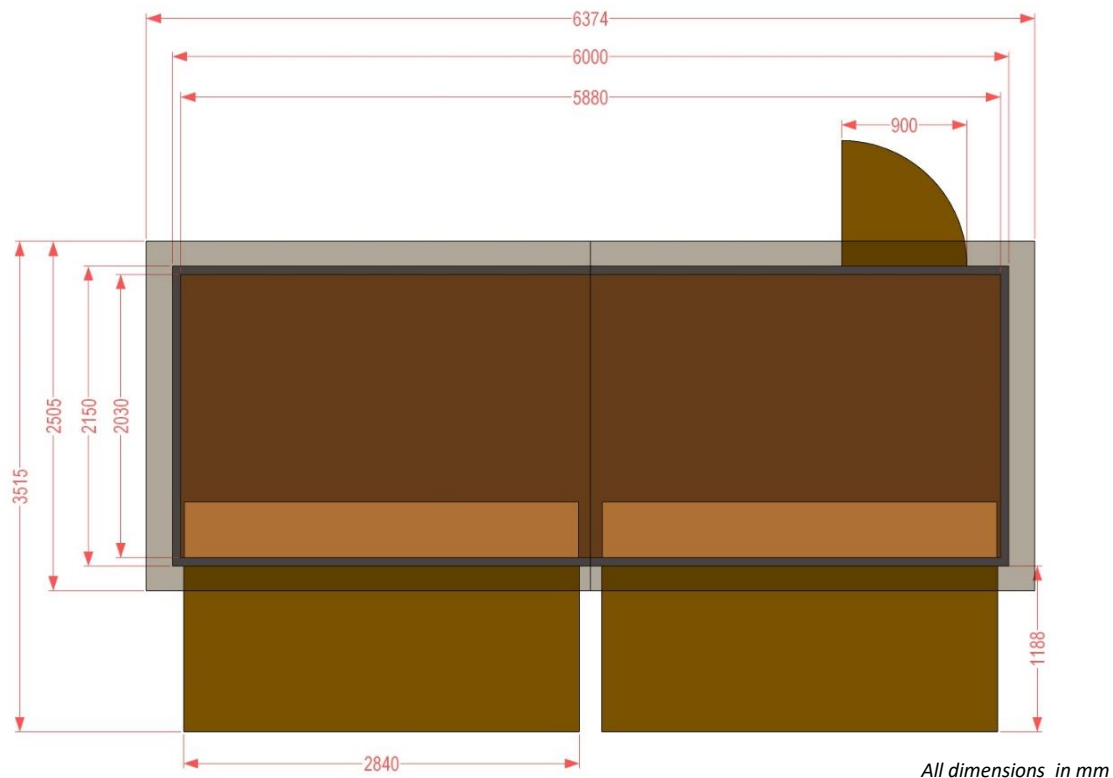

| | | |
|-------------------|------------------------------------------------------------------------------------------------------------------------------------------------------------------------------------------------------------------------------------------------------------------------------------------------------------------------------------------------------------------------------------------|----------------------------|
| Dimensions | W x D x H (base area) | 6.00m x 2.15m x 3.08m |
| | Dimensions with open front flaps (W x D) | 6.37m x 3.51m |
| | Roof overhang front side back | 0.18m 0.18m 0.18m |
| | W x D (with roof overhang) | 6.37m x 2.50m |
| | Counter (W x D) | approx. 2.83m x 0.40m (2x) |
| | Counter height (inside outside) | 0.80m 1.00m |
| | Door width | 0.90m |
| General | <ul style="list-style-type: none"> - Hut in solid modular construction - Solid wooden floor (can be used as forklift pallet) - Walls and bottom are screwed together - Sales flaps at the front (standard) - Door in the back wall - Inlet for cables and hoses in the back wall - Foldable counters (at the front) | |
| Options | <ul style="list-style-type: none"> - Sales flaps on the side - Sales flaps in the back wall - Tür seitlich - Hut can be configured fully or partially walkable (front consists of 2 elements) - Glazing bar windows - Shutters - Further options available upon request | |

Datasheet
Rustic market hut "6m hut"
6.00m x 2.44m

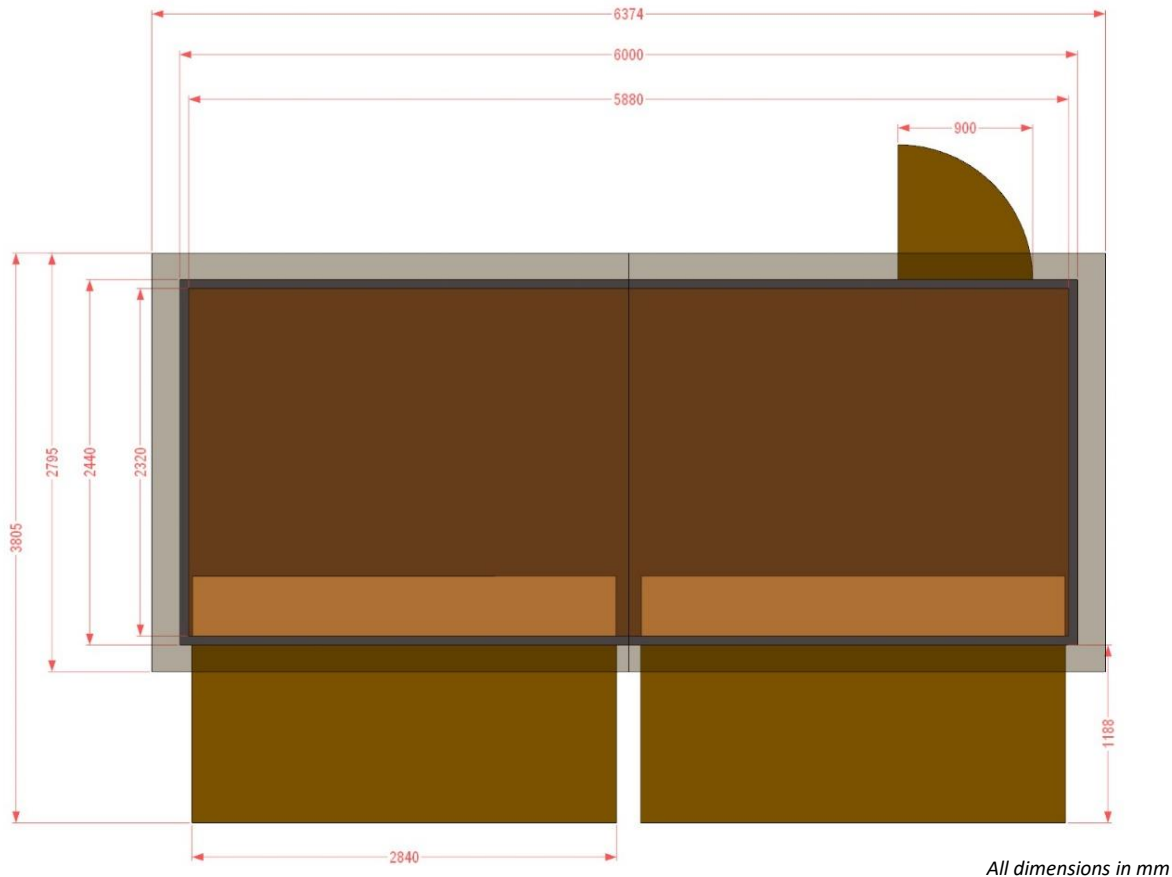

All dimensions in mm

| | | |
|-------------------|------------------------------------------------------------------------------------------------------------------------------------------------------------------------------------------------------------------------------------------------------------------------------------------------------------------------------------------------------------------------------------------|----------------------------|
| Dimensions | W x D x H (base area) | 6.00m x 2.44m x 3.08m |
| | Dimensions with open front flaps (W x D) | 6.37m x 3.80m |
| | Roof overhang front side back | 0.18m 0.18m 0.18m |
| | W x D (with roof overhang) | 6.37m x 2.79m |
| | Counter (W x D) | approx. 2.83m x 0.40m (2x) |
| | Counter height (inside outside) | 0.80m 1.00m |
| | Door width | 0.90m |
| Basis | <ul style="list-style-type: none"> - Hut in solid modular construction - Solid wooden floor (can be used as forklift pallet) - Walls and bottom are screwed together - Sales flaps at the front (standard) - Door in the back wall - Inlet for cables and hoses in the back wall - Foldable counters (at the front) | |
| Options | <ul style="list-style-type: none"> - Sales flaps on the side - Sales flaps in the back wall - Door on the side - Hut can be configured fully or partially walkable (front consists of 2 elements) - Glazing bar windows - Shutters - Further options available upon request | |

Datasheet
Rustic market "6m hut"
6.00m x 5.26m

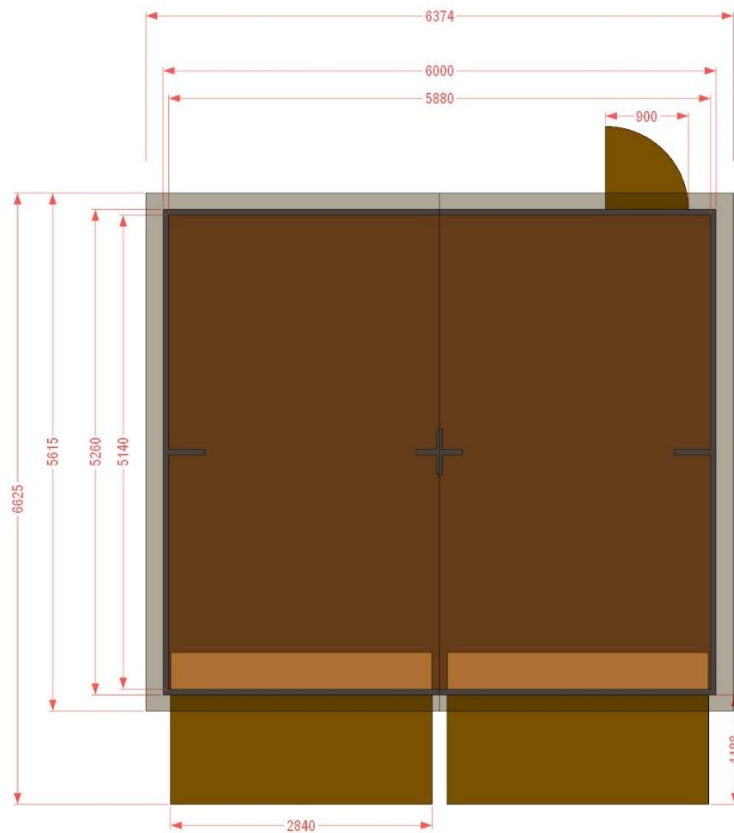

Alle Maße in mm

| | | |
|-------------------|------------------------------------------------------------------------------------------------------------------------------------------------------------------------------------------------------------------------------------------------------------------------------------------------------------------------------------------------------------------------------------------|----------------------------|
| Dimensions | W x D x H (base area) | 6.00m x 5.26m x 3.08m |
| | Dimensions with open front flaps (W x D) | 6.37m x 6.63m |
| | Roof overhang front side back | 0.18m 0.18m 0.18m |
| | W x D (with roof overhang) | 6.37m x 5.62m |
| | Counter (W x D) | approx. 2.83m x 0.40m (2x) |
| | Counter height (inside outside) | 0.80m 1.00m |
| | Door width | 0.90m |
| General | <ul style="list-style-type: none"> - Hut in solid modular construction - Solid wooden floor (can be used as forklift pallet) - Walls and bottom are screwed together - Sales flaps at the front (standard) - Door in the back wall - Inlet for cables and hoses in the back wall - Foldable counters (at the front) | |
| Options | <ul style="list-style-type: none"> - Sales flaps on the side - Sales flaps in the back wall - Door on the side - Hut can be configured fully or partially walkable (front consists of 2 elements) - Glazing bar windows - Shutters - Further options available upon request | |